



## E-CRS-100

### CORIOLIS TYPE FLOW METER & WEIGH FEEDER



#### ■ DEFINITION

E-CRS-100 type Solid flow meter is developed by using coriolis theory. It is used to measure and control the flow rate of flowing solids with high accuracy at different industries.

E-CRS-100 type Coriolis flowmeter is controlled by E-AC-1000-CRS type controller. It provides high accuracy and reliability. E-CRS-100 provides 0.5 % accuracy for high and medium flowing solid materials from 1m<sup>3</sup>/hr to 80 m<sup>3</sup>/hr flow rates.

#### ■ GENERAL PROPERTIES

- Easy installation
- High accuracy and repeatability
- High reliability
- Low maintenance cost
- Automatic calibration increase accuracy and reliability.

## TECHNICAL PROPERTIES

Accuracy	± % 0.5
Capacity	2- 80 m <sup>3</sup> /h E-CRS-100-20 20 m <sup>3</sup> /h E-CRS-100-40 40 m <sup>3</sup> /h E-CRS-100-80 80 m <sup>3</sup> /h
Material Temperature	-5/+70°C
Operation Temperature	-20/+50°C
Motor	1.1 kW-4 kW AC Motor
Rotor Speed	200- 500 RPM 50 Hz
Protection Class	Motor IP65 Load cell IP67
Load Cell	2x50,100 kg
Power Supply	400 V AC±10%, 50/60 Hz. 5 KW
Material	Size min. 0.1 mm and max. 3 mm. Bulk density: 0.3 t/m <sup>3</sup> < 2.5 t/m <sup>3</sup>
Controller	E-AC-1000-CRS

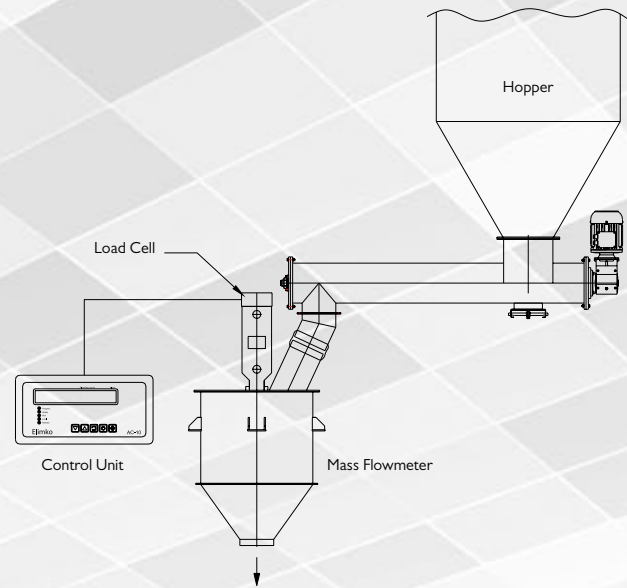

### FOLLOWING FEEDERS CAN BE USED FOR DOSING APPLICATION

1. Screw Feeders
2. Dosier valve with air slide

### ORDERING INFORMATION

In order to obtain the correct and accurate measurement, material and installation site information should be provided.

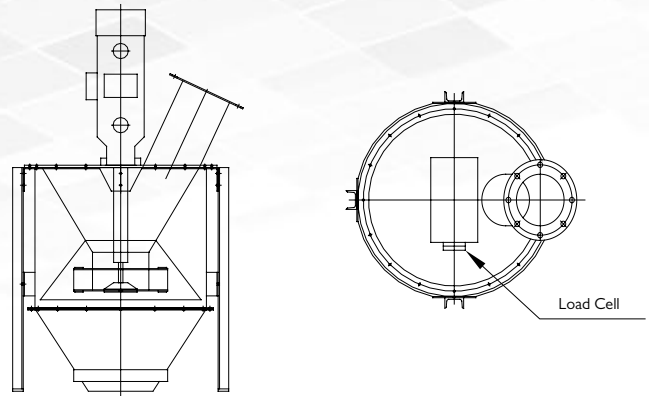

## STANDARD TYPES

TYPE	CAPACITY m <sup>3</sup> /hr
E-CRS-100-20	20
E-CRS-100-40	40
E-CRS-100-80	80

The company's policy is one of continuous product improvement and the right is reserved to modify the information contained here in without notice.

**\* Please contact with Elimko for your special applications.**



The company's policy is one of continuous product improvement. We reserve the right to modify the information contained herein without notice.

