



TW/W

WELD-IN SOCKETED TYPE THERMOWELLS



**TW/WS Weld-in Socketed Type
Straight Thermowell**



**TW/WT Weld-in Socketed Type
Tapered Thermowell**



**TW/WS_t Weld-in Socketed Type
Stepped Thermowell**

■ GENERAL

Thermowells are protecting tubes which are manufactured by solid bar stock or pipe material to protect thermocouples, resistance thermometers and other temperature sensors. Especially, they are used widely in critical applications where pressure, viscosity, fluid velocity, chemical and mechanical corrosive abrasive materials are present individually or in combination.

A properly selected thermowell will protect the temperature sensor from possible damage resulting from these process variables. A thermowell permits removal of the temperature sensors for replacement, repair or testing without effecting the process or system.

■ ELIMKO THERMOWELLS

Elimko thermowell types in process applications;

TW/T : Threaded Type
TW/F : Flanged Type

TW/W : Weld-in Socketed Type
TW/WI : Weld-in Type

TW/V : Vanstone Flanged Type

STANDART FEATURES

Bar Materials			Bore Diameter
ASTM A304	DIN 1.4571	INCOLOY 825	5.0 mm
ASTM A316 Ti	DIN 1.4749	HASTELLOY C4	6.0 mm
ASTM A316 L	DIN 1.4828	BRASS	6.6 mm
ASTM A310	DIN 1.4841	PTFE	7.0 mm
ASTM A321	DIN 1.7335 MOLIBDEN		8.0 mm
ASTM A446	INCONEL 600		9.0 mm
ASTM A105	INCOLOY 800		10.0 mm

Note 1: Elimko Thermowells can be produced additionally to the standart bore diameters, it is also possible to produce bore diameters from 4 mm to 22 mm, up to maximum 1200 mm length.

Note 2 : The above mentioned solid bar stock materials are our standart types. Special materials could be supplied upon receipt of satisfactory orders.

Others : Haynes 25, Carpenter, 20 CB, Nichrome, HCF, 50Co-30Cr, Monel 400, Titanium, Tantalum, X-750, B, C276, X.

Note 3 : Satellite coating can be produced against abrasion.

Tests

Thermowells can be tested after produced on request. These tests are made by special institutions for a fea.

- a- Pressure tests
- b- X-ray tests

TW/W WELD-IN SOCKETED TYPE THERMOWELL CODING

TW/WS Straight

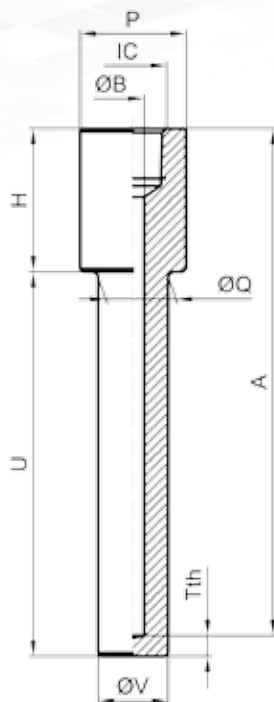

TW/WT Tapered

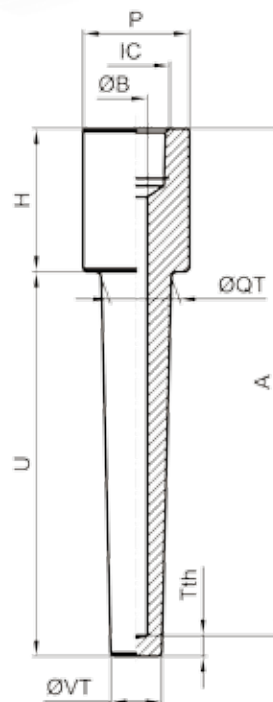

TW/WS_t Stepped

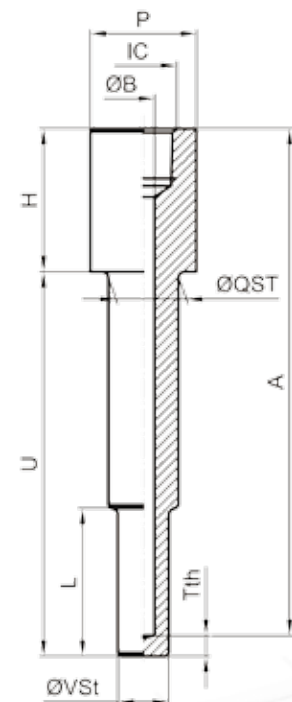

P : Welding Diameter
 Ø IC : Instrument Connection
 Ø B : Bore Diameter
 H : Head Lenght

U : Insertion Length
 A : Stem Length
 Ø Q/QT/QSt : Stem/Root Diameter
 Ø V/VT/VSt : Type Diameter

Tth : Type Thickness
 L : Type Length

TW	W	01	02	03	04	05	06	07	08	09	10	11	12	13	14
Type	B	Pr/t	Pr/s	P	IC	H	U	L	A	Q	V	Tth	Wm	O	
Bore Diameter	Production Type	Production Standard	Welding Diameter	Instrument Connection	Head Length	Insertion Length	Type Length	Stem Length	Stem/Root Diameter	Type Diameter	Type Thickness	Well Material	Options		

TW	W	Weld-in Socketed Type Thermowells
	WS	Straight Type
W	WT	Tapered Type
	WSt	Stepped Type

01	B	Bore Diameter
B	Please write B diameter like B Example: B 6

02	Pr/t	Production Type
Pr/t	SB	Solid Bar Drilled
	SBT	Solid Bar Tapered
	P	Pipe

03	Pr/s	Production Standard
Pr/s	M	Metric
	I	Non Metric

04	P	Welding Diameter	
P	P01	26,4 mm	
	P02	33,4 mm	
	P03	48,3 mm	
	P21	3/4"	1.050 "
	P22	1"	1.315 "
	P23	1 1/2"	1.900 "
	P....	*	

05	IC	Instrument Connection
IC	IC01	M20x1.5
	IC21	1/2" NPT
	IC....	*

06	H	Head Length
H	H01	45 mm
	H21	1 3/4"
	H....	*

07	U	Insertion Length
U	Please write U length like U Example: U 100

08	L	Type Length
L	L00	No Stepped
	L01	50 mm
	L02	65 mm
	L21	2"
	L22	2 1/2"
	L....	*

09	A	Stem Length
A	Please write A length like A Example: A 150

10	Q	For TW/WS - TW/WT - TW/WSt Stem/Root Diameter
Q		Welding Diameter
	Q01	19 mm P21 için
	Q02	25 mm P22 için
	Q03	38 mm P23 için
	Q21	3/4" P21 için
	Q22	1" P22 için
	Q23	1 1/2" P23 için
	Q....	*

11	V	For TW/WS Type Diameter
V		Process Connection
	V01	19 mm for P21
	V02	25 mm for P22
	V03	38 mm for P23
	V21	3/4" for P21
	V22	1" for P22
	V23	1 1/2" for P23
V....	*	

11	VT	For TW/WT Type Diameter
VT	VT01	16 mm
	VT02	19 mm
	VT21	5/8"
	VT22	3/4"
	VT....	*

11	VSt	For TW/WSt Type Diameter
VSt	VSt01	12,7 mm
	VSt21	1/2"
	VSt....	*

12	Tth	Type Thickness
Tth	Tth01	6 mm
	Tth21	1/4"
	Tth....	*

* Please give the Process Connection (P), Instrument Connection (IC), Head Length (H), Type Length (L), Stem/Root Diameter (Q,QT, QSt), Type Diameter (V, VT, VSt), Type Thickness (Tth), Well Material (Wm), Flange Material (Fm) and Options (O) of the thermowells, if they are not exist on the tables.

** Please apply to Elimko for these kinds of well and flange materials.



13	Wm	Well Material	14	O	Options
Wm	Wm01	ASTM A304	O	O01	Screw Plug and Chain
	Wm02	ASTM A316 Ti		O02	Tag No Written on SS Plate
	Wm03	ASTM A316 L		O03	Pressure Test
	Wm04	ASTM A310		O04	Material Certificate
	Wm05	ASTM A321		O...	*
	Wm06	ASTM A446			
	Wm07	ASTM A105			
	Wm08	DIN 1.4571			
	Wm09	DIN 1.4749			
	Wm10	DIN 1.4828			
	Wm11	DIN 1.4841			
	Wm12	DIN 1.7335 MOLIBDEN			
	Wm13	INCONEL 600 **			
	Wm14	INCOLOY 800 **			
	Wm15	INCOLOY 825 **			
	Wm16	HASTELLOY C4 **			
	Wm17	MONEL 400 **			
Wm...	*				

■ EXAMPLES

TW/WS-B6-SB-M-P02-IC21-H01-U 250-L00-A 290-Q02-V02-Tth01- Wm03-O01-O02

Well Type (TW) = TW/VS Weld-in Socketed Type Straight Thermowell,
Bore Diameter (B) = 6 mm, **Production Type (SB)** = Solid Bar Drilled, **Production Standard (M)** = Metric,
Welding Diameter (P02) = 33.4 mm, **Instrument Connection (IC21)** = 1/2" NPT,
Head Length (H01) = 45 mm, **Insertion Length (U)** = 250 mm, **Type Length (L00)** = No stepped,
Stem Length (A) = 289 mm, **Stem/Root Diameter (Q02)** = 25 mm, **Type Diameter (V02)** = 25 mm,
Type Thickness (Tth01) = 6 mm, **Well Material (Wm03)** = 316 L
Options (001) = Screw Plug and Chain / **(002)** = Tag No Written on SS Plate

■ HOW TO ORDER

Select one of the types of TW/T, TW/W, TW/W, TW/V, TW/F and TW/WI according to the process. And specify; thermowell material, process connection, connection type, type of the flange (if flanged), it's material, bore diameter, insertion length, length of connection.



The company's policy is one of continuous product improvement. We reserve the right to modify the information contained herein without notice.



in /elimkoldsti
f /elimkoldsti
yt /elimkoldsti